

GN 163.1

Bases for linear actuators

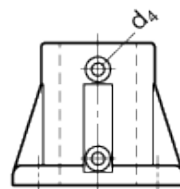

Adjustable clamping lever GN 911

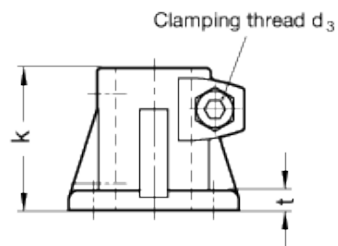
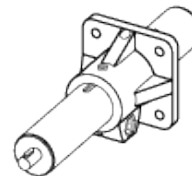
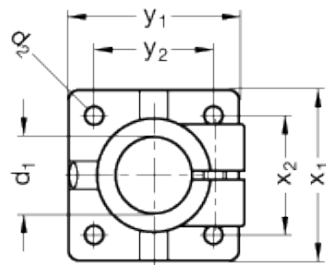
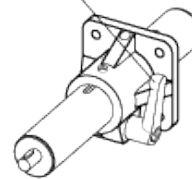

technical informations

Material

Aluminium.

Finish

Version SW: RAL 9005 black colour, matte finish, epoxy resin coating.

Clamping screws

Identification no. 2: with AISI 304 stainless steel-clamping screw DIN 912 and nut DIN 985.

Assembly

The standard clamping bolts are socket cap screws DIN 912, supplied assembled. They can be replaced by clamping kits GN 911 (description see table of dimensions).

Features and applications

Linear actuator connectors GN 163.1 are normally supplied only in connection with a mounted linear actuator and for function control.

By means of the clamping screw on the guide bore d_1 the movement can either be set or the linear actuator connector can be clamped (after setting of final adjustment).

Accessories

- Tubings [GN 990](#).
- Linear actuators GN 293 to 293.
- Clamping kits [GN 911](#) (clamping handles GN 300.1 with distance bushing).

Standard Elements	Main dimensions												Clamping kits	Weight
	Description	d_1 Bore without slider bush	d_1 Bore with slider bush	d_2	d_3	d_4	k	t	x_1	x_2	y_1	y_2		
GN 163.1-B30-2-SW	B 30	-	6.5	M 8	M 4	50	7	60	42	60	42	GN 911-M8-32	145	
GN 163.1-G30-2-SW	-	G 30	6.5	M 8	M 4	50	7	60	42	60	42	GN 911-M8-32	130	
GN 163.1-B40-2-SW	B 40	-	8.5	M 10	M 5	70	10	90	64	90	64	GN 911-M10-40	430	
GN 163.1-G40-2-SW	-	G 40	8.5	M 10	M 5	70	10	90	64	90	64	GN 911-M10-40	400	
GN 163.1-B50-2-SW	B 50	-	11	M 10	M 6	85	14	105	74	105	74	GN 911-M10-55	700	
GN 163.1-G50-2-SW	-	G 50	11	M 10	M 6	85	14	105	74	105	74	GN 911-M10-55	650	
GN 163.1-B60-2-SW	B 60	-	11	M 10	M 8	100	14	125	89	125	89	GN 911-M10-55	1020	
GN 163.1-G60-2-SW	-	G 60	11	M 10	M 8	100	14	125	89	125	89	GN 911-M10-55	1020	



STANDARD MACHINE ELEMENTS WORLDWIDE